

BeA - Druckluftnagler Typ 14/40- 713C deutsch

- [1] Abmessungen: L = 254; H = 228 B = 70 mm;
- [2] Gewicht: 2,2 kg.
- [3] Zulässiger Luftdruck: 8 bar;
- [4] empfohlener Betriebsdruck: 5 - 8 bar.
- [5] Luftverbrauch pro Eintreibvorgang bei 6 bar:
1,0 l freie Luft.
- [6] Eintreibgegenstand: Industrieklammern Typ 14 und 16 (155) in den Längen von 15 bis 40 mm.
- [7] A-bewerteter Einzelereignis-Schalleistungspegel $L_{Wa,1s} = 91$ dB
- [8] A-bewerteter Einzelereignis-Emission Schalldruckpegel am Arbeitsplatz $L_{pA,1s} = 82$ dB
- [9] *Vibrationskennwert 3,0 m/s.
- [10] Magazinart: Oberlader
- [11] Ladekapazität: min 14er/110 oder 16 (155)er/102 Klammern
- [12] Luftanschluß: 9 bis 10 mm Nennweite

Diese Ersatzteilliste/Servicehinweise bildet mit dem beiliegenden Benutzer-Handbuch die Betriebsanleitung. Bitte vor Inbetriebnahme aufmerksam lesen und Sicherheitshinweise unbedingt beachten.

BeA Pneumatic Stapler Type 14/40-713C English

This Spare parts list/service instructions and the enclosed Operator's Manual constitute the Operating Instructions. Before using read both and strictly observe safety instructions. In the German section of the spare parts list the technical data are listed under codes [] (also see User Manual).

Attention! Always disconnect the tool from its air supply and empty magazine before attempting any repair. Always fix the cap with a torque wrench adjusted to 7 Nm.

Removing piston and driver blade

Take out 4 bolts 13301126 and remove the complete cap and valve shaft 14404494 (fig. 1). The piston with driver blade can now be removed by using a spare driver blade and pushing them from below (fig. 2). Use a pin punch 3.5 mm diameter and BeA mounting block 14401094 for removing the pin 14401573 and split pin 13300260 (fig. 3). Any damaged parts must be replaced. Before refitting, the piston O-ring should be greased with BeA special grease 13301706

Changing of bumper and cylinder

Take off bolts 13301137, 13301110 and 13301117 now remove magazine. Take out piston-driver set and bumper. Gently tap the housing on a wooden surface. By the impact, the cylinder will come out and can easily be removed from the housing. Replace the damaged parts and grease before refitting (fig. 4).

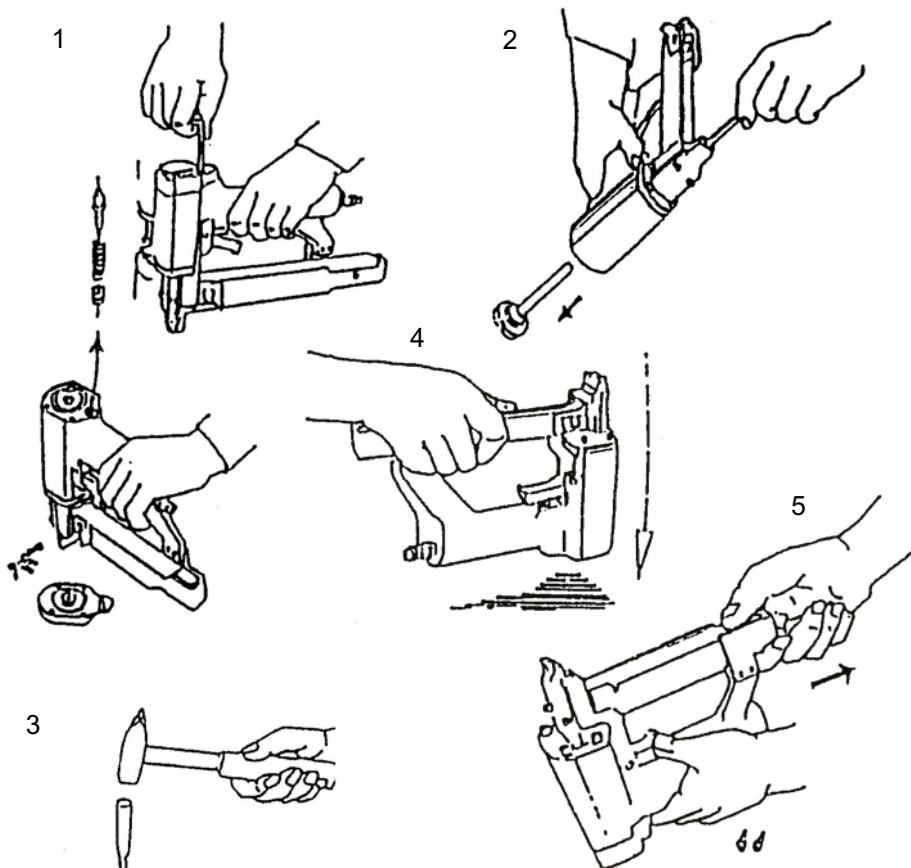

Replacement of feeder bar and roller spring

Remove the 2 screws 13301117 and slide the staple carrier backwards out of the nailer. Roller spring and feeder bar can easily be removed and replaced, if necessary (figure 6).

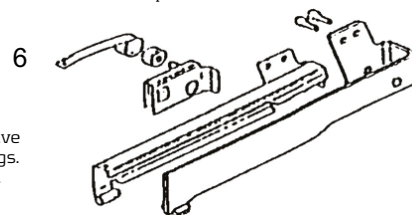

Changing of O-rings on valve system

Remove the cap as described above. Take main valve 14404548 out of the cap and replace worn O-rings. Grease O-rings with special BeA grease 13301706.

1	O-Ring	13300002						
2	O-ring	13300008						
3		13302610	25	Kolben Piston	14401659	38	Puffer Bumper	14404482
4		13300029				39	Gehäuseverschraubung Reducing bush	14404486
5		13300042				40	Gehäuse Body	14404489
6		13300085	26	Druckfeder Pressure spring	14401688 13302648	41	Zylinder Cylinder	14404493
7		13300095	27		14403598	42	Ventilstange Valve shaft	14404494
8		13300113	28			43	Kopfstück Nose housing	14404502
9		13300118	29	Federteller Disc	14402118	44	Auslösesicherung Safety yoke	14404503
10		13300119				45	Werkzeug Teil 1 Front nose	14404505
11		13300130	30	Lochblech Perforated plate	14403585 14404543	46	Schubkasten Feeder bar	14404407
12		13300147	31			47	Klammerträger Staple carrier	14404508
13	Spannhülse Split pin	13300260	32	Schalldämpfer Silencer	14403589	48	Schubkastenarretierung Feeder stop	14404509
15	Sicherungsscheibe Circlip	13300349	33	Kappeneinsatz Cap insert	14403592	49	Werkzeug Teil 2 Back nose	14404510
16	Zylinderschraube	13301110	34	Ventilhebel Trigger	14404337	50	Treiber Driver blade	14404511
17	Allen bolt	13301120	35	Abdeckeschiene Cover	14404357	51	Dichtscheibe Gasket	14404540
18		13301126	36	Spule Spool	14404360	52	Kappe Cap	14404545
19		13301137	37	Rollfeder Roller spring	14404361	53	Auslaßventil Exhaust valve	14404547
20	Buchse bushing	14404607				54	Hauptventil Main valve	14404548
21	Schraube Screw	13301117				55	Ventilbuchse Valve bush	14404551
22	Anschlußsnippel Air hose connector	14000248				56	Treiberführung Driver guide	14404575
23	Dichtscheibe Gasket	14400063				57	Auslösesicherung mit RapidClip-Anschlag Safety yoke - RapidClip	31910000
24	Stift Pin	14401573				75	Zylinderschraube Allen bolt	14406353

Made in Germany